

# Installation Instructions for Slurry King Hose

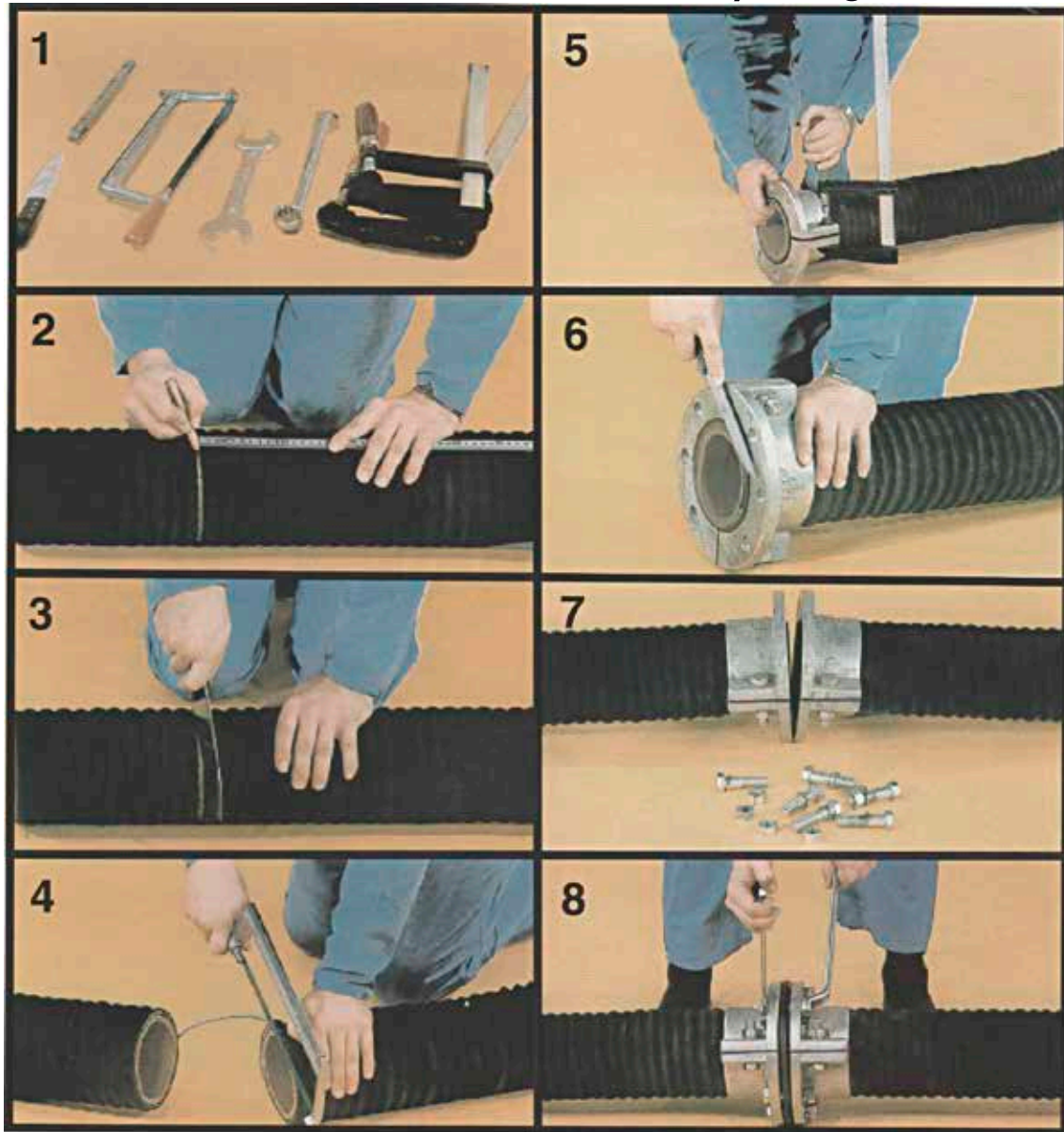

1. Tools required: Measuring tape, chalk, knife, hacksaw, clamps and wrenches.
2. Measure and mark the required length of hose. Add a little extra length for trimming (see photo) and lateral overlap.
3. Cut off the marked length of hose plus the extra length, using a sharp wet cutting tool, such as a knife.
4. Pull the cut surfaces apart so that the steel helix can be pulled out of the rubber. Cut off the steel helix.
5. Place the two halves of Slurry King hose coupling parts 1 and 2 at the position marked and clamp them together to

- the point where they are snug on the hose. Do not clamp the two halves flush together, leave a gap. The end of the hose should extend about  $\frac{1}{8}$ " beyond the flange of the coupling.
6. Installation is complete when the bolt hole circle matches the ANSI 150 pattern for the diameter of the hose. There will be a small gap between the two flange halves. Do not bolt the two halves completely flush as this will result in an incorrect bolt hole circle. A sealing gasket can be used as a template to measure the bolt hole circle.

The information provided within is for informational purposes only. We have made every effort to ensure the accuracy of the provided information and assume no responsibility for any loss or damage due to errors or omissions or to the use or misuse of any information supplied. It is impossible to test all products under all conditions to which they might be subjected in the field. It is therefore the buyer and/or end users' responsibility to test all products under the conditions that duplicate the service conditions prior to installation. All improvements, all specifications are subject to change without prior notice. It is the buyer and/or end users' responsibility to review our complete **Terms and Conditions of Sale** located on our web sites at: [www.novaflex.com](http://www.novaflex.com) | [www.z-flex.com](http://www.z-flex.com) | [www.flexmaster.com](http://www.flexmaster.com).

<b>Canada</b>	<b>U.S.A.</b>		
<b>Ajax, Ontario</b>	<b>West Berlin, NJ</b>	<b>Indianapolis, IN</b>	<b>Burlington, NC</b>
Tel: 905.686.5200	Tel: 856.768.2275	Tel: 317.334.1444	Tel: 336.578.2161
Fax: 905.686.8349	Fax: 856.768.2385	Fax: 317.334.1535	Fax: 336.578.5554
	1.800.225.0215	1.800.526.6288	1.800.334.4270